

BXM(D)-DIP

系列粉尘防爆照明(动力)配电箱(DIP)

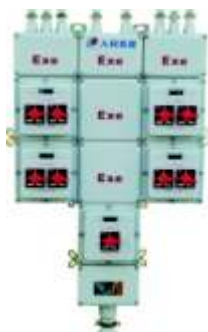

Application

- Can be used in hazardous areas: Zone 20、Zone 21 and Zone 22.
- Can be used in explosive or flammable dust atmosphere.

Model implication

BX M(D)-DIP □ □ / □ □ □ □ □ □ □ □

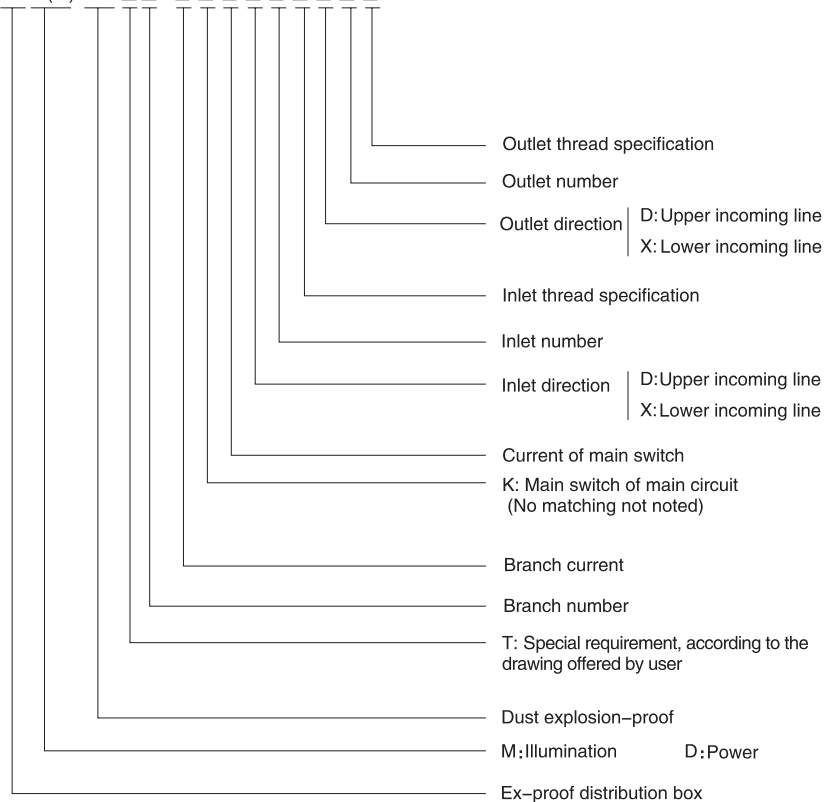

BXM(D)-DIP

Type dust explosion-proof distribution box (DIP)

Main technical parameters

- Implementing the standard : GB 12476.1
- Explosion-proof mark: DIPA20TA, T₆
- Rated voltage: AC 380/220V
- Rated current of main circuit: 60~250A
- Protection grade: IP65
- Explosion-proof class: WF1

Type	Branch number	Switch No. Of main circuit	Rated current of main circuit	Thread		Cable's outer diameter	
				Inlet	Outlet	Inlet	Outlet
BXM(D)-DIP4	4		1	G1 1/4" ~ G3"	G1 1/2" ~ G1 1/2"	φ 14-55	φ 6-28
BXM(D)-DIP6	6		3				
BXM(D)-DIP8	8		5				
BXM(D)-DIP10	10		10				
BXM(D)-DIP12	12		15				
BXM(D)-DIP4K	4	1	20	G1 1/4" ~ G3"	G1 1/2" ~ G1 1/2"	φ 14-55	φ 6-28
BXM(D)-DIP6K	6		25				
BXM(D)-DIP8K	8		32、40				
BXM(D)-DIP10K	10		50				
BXM(D)-DIP12K	12		60				

Features

- The housing is die cast in aluminum alloy, with high voltage static plastic-sprayed surface.
- The shell is made of diecasted Al-alloy, inside is installed MCB or MCCB. Has DZ47, RDM1 to be supplied.
- With protections of overload and short-circuit, electrical leakage protection is able to add to the user's requirement.
- Conduit wiring or cable wiring.
- Special type can be made.

BXM(D)-DIP

Type dust explosion-proof distribution box (DIP)

Outline and mounting example

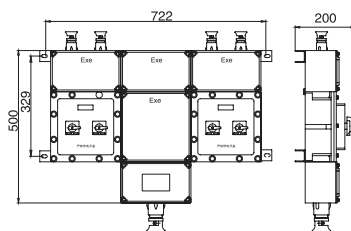

BXM(D)-DIP4

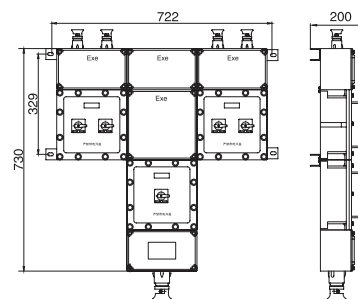

BXM(D)-DIP4K

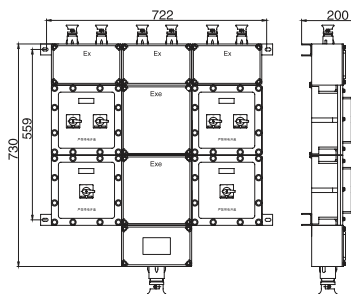

BXM(D)-DIP6

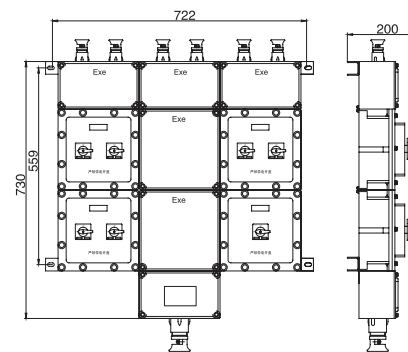

BXM(D)-DIP6K

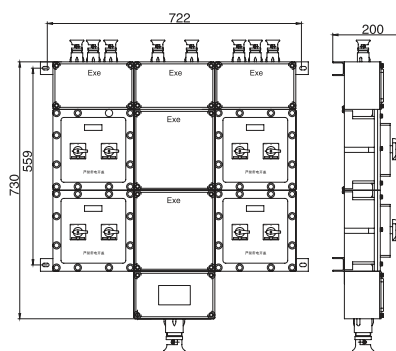

BXM(D)-DIP8

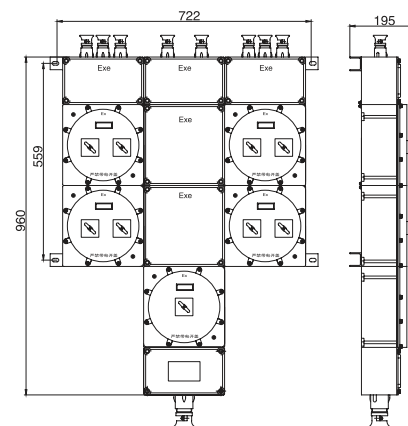

BXM(D)-DIP8K

BXM(D)-DIP

Type dust explosion-proof distribution box (DIP)

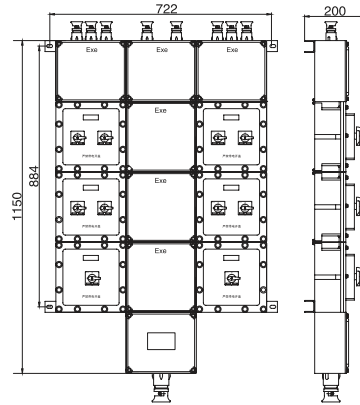

BXM(D)-DIP10

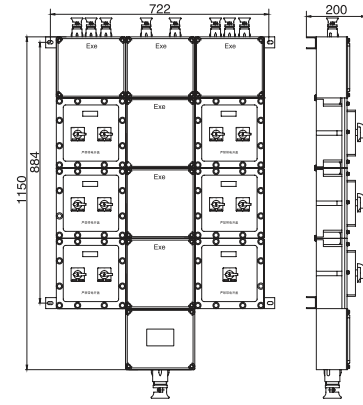

BXM(D)-DIP10K

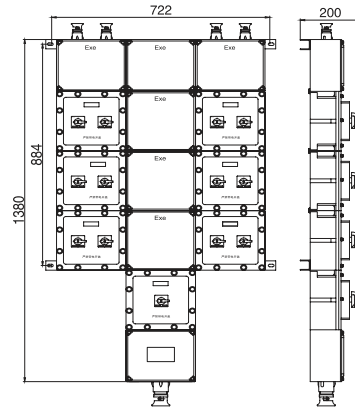

BXM(D)-DIP12K

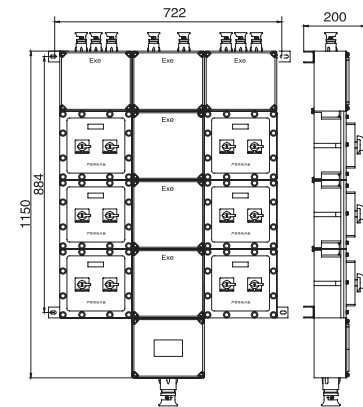

BXM(D)-DIP12

Not ice if ordering

- When placing an order, please indicate the circuit number of distribution box, corresponding current of each circuit, pole number of circuit breaker and so on, and give indication if need earth leakage protection function;
- If need mains switch, please indicate the current and pole number as well as incoming/outgoing lines' direction and thread specification and corresponding number;
- Above are routine products of BXM(D)-DIP series, we also can make special designs according to customers' electrical system drawings.